

NWP-2

2MP Phablet Temperature Detection Camera

Key Features:

- 1/2.8" Progressive Scan CMOS
- 25fps @ 2MP(1920*1080)
- On-Board Temperature Detection
- Fixed 4.5mm Lens
- Full screen Human Temperature Detection
- Accurate to within 0.3°C
- Multiple brackets; variety of installation possibilities

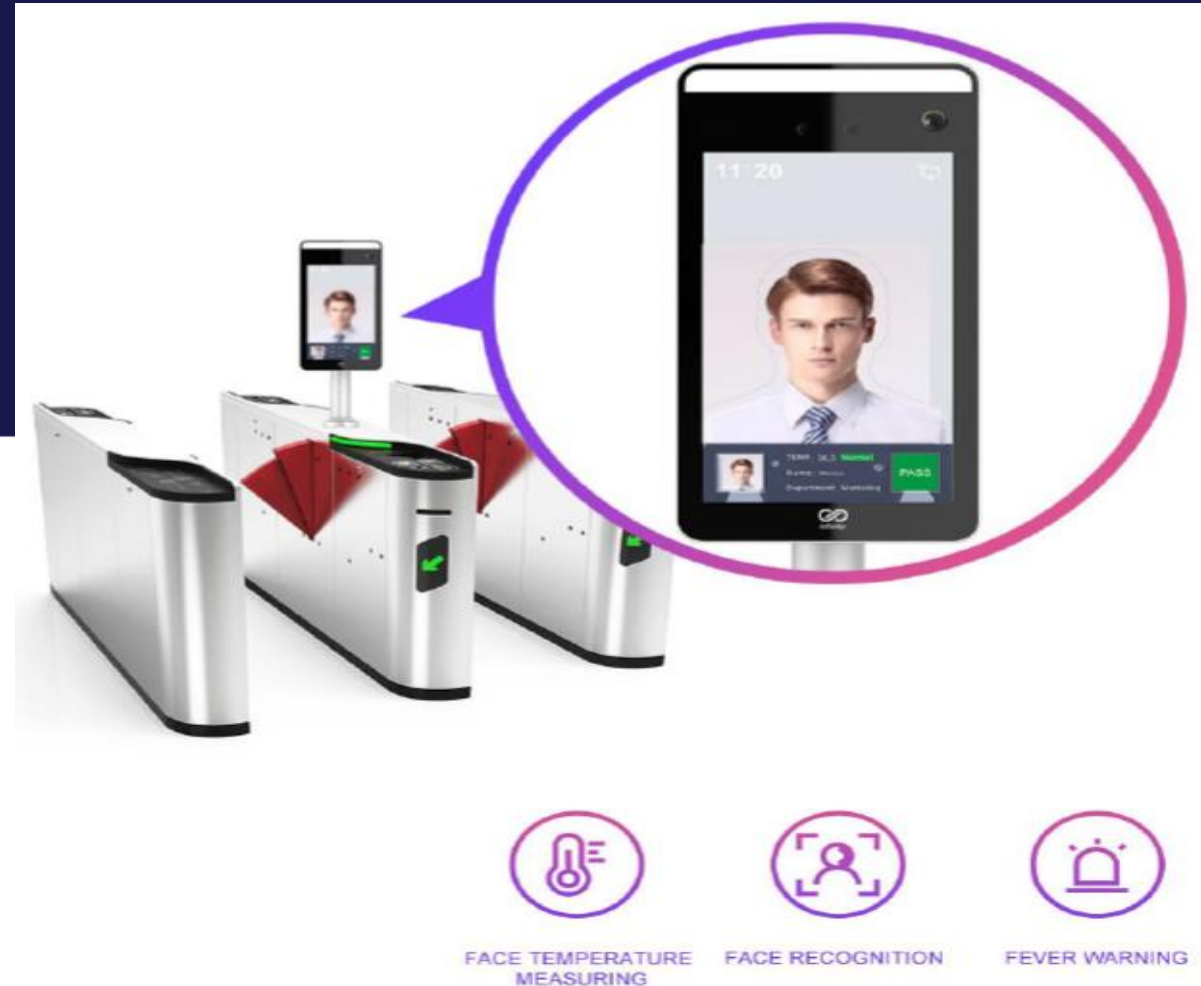

Product Overview

Infinity cameras bring together the power of **Facial Recognition** and **Temperature Detection** to help protect the **Security, Safety** and **Integrity** of your world.

The visual HD camera allows for real-time HD video both front-facing and accessible via secure web browser interface. The camera is able to record faces and thus perform real-time facial recognition to anyone who appears 'front on' to the unit; the security of your premises can be conducted contact-free via facial recognition – even for those who wear face masks during pandemics.

The Temperature Sensor is built in and is combined with the HD camera; anyone who approaches the unit has their temperature detected and shown; anyone who is above a determined threshold can be denied access into a building.

Thus the combination of Facial Recognition and Temperature Detection ensures only those who are given access can enter a building and **only** those whose temperature is normal can enter a building thus the security, integrity and most importantly, **safety**, of your world is ensured.

SMART CONTROL AND PREVENTION

Non-contact face recognition and temperature detection make controlled areas more secure, accurate and efficient.



Features

HD Video and Temperature Detection

Temperature analytics with within 0.3° accuracy on humans combined with HD front facing camera for Facial Recognition; up to 30,000 stored faces per system.

Environmental

With an operating temperature range of -20 °C to +60 °C the camera is perfectly suited to man environments and applications such as Schools, Offices, Factories and more!



▶ TABLE BRACKET

**FLOOR POLE
BRACKET**



WALL BRACKET





Accurate Face Recognition

Non touch temperature measuring Face recognition

Face recognition within 0.5m-2.2m distance while collecting human body temperature, wearing a face mask is also applicable, and better prevents cross infection.

- 

Temperature measurement
distance 0.5-1.0m
- 

Face recognition speed
≈200 ms
- 

Recognition accuracy
99.5%
- 

Temperature error
± 0.3 °C
- 

Abnormal body
temperature
Automatic warning
- 

Face library capacity
30000 persons
- 

7" IPS HD screen



QUANTUS

INFORMATION SERVICES LTD



IT Services



Managed Print



Telecoms



Security Solutions



Web Design



Data Services

Sales@qisltd.co.uk or 0330 400 4334

Quantus Information Services Ltd

Unit 2, Links Industrial Estate, Popham Close, Hanworth, Middlesex, TW136JE